

INDUSTRIAL FOR LEASE

AVAIL SF: 2,372

TOTAL BLDG SF: 16,863



ADDRESS 1695 DEL AMO BL, CARSON CA ZIP 90746

Small CTU Industrial Park – End Unit Access To 405, 110, 91 & 710 Fwys. Unit To Be Refurbished

LEASE RENTAL \$ 1,895 /mo Gross 0.799 Net _____ Term ACCEPTABLE TO OWNER
 SALE PRICE \$ NFS Price/SF \$ _____ Tax \$ 1,080.00 Yr 2007-2008
 Terms _____ Possession D-10/01/08
 Avail SF 2,372 Dim IRR X IRR Power A 125 V 120-240 Ø 1 W 3
 Min. SF 2,372 Dim IRR X IRR Lighting VERIFY Heat VERIFY Cooling VERIFY PWR Notes VERIFY
 Land SF POL Dim IRR X IRR Trk Hi Pos 0 Dim _____
 Const CTU Roof VERIFY Grd Lev Drs 1 Dim _____ Well N
 Rail NONE Unfin Ofc Mezz SF TBD Incl in Avail SF N Rest Rms: M TBD W TBD
 Sprkd NO Min Clr Hgt 14 OFFICE DATA Ofc SF 276 # TBD Rest Rms: M TBD W TBD
 Pkg 4 Fenced N Yr Blt 1969 A/C VERIFY Heat VERIFY Fin Ofc Mezz SF TBD Incl in Avail SF N
 Thomas Bk Pg# 764-G4 Zone ML To Show Call Broker - FOR APPOINTMENT Sp. Feat. _____
 AGENT Douglas E Wells (562)908-6012 x203 Region S Listing # 1200338
 FIRM Penta Pacific Properties 08/22/08
 FTCF CB250N000S000/AOAA Notes Occupied. Lease Terms: 3-5 Years Or Submit. Sp. Feat: Part of Industrial Park. # Of Offices: 2.

THIS IS A LISTING OF THE "MULTIPLE" AND IS SUBJECT TO ALL ITS APPLICABLE RULES AND REGULATIONS

This information has been furnished from sources which we deem reliable, but for which we assume no liability. The information contained herein is given in confidence, with the understanding that all negotiations pertaining to this property be handled through the submitting office. All measurements are approximate.
 © American Industrial Real Estate Association



INDUSTRIAL FOR LEASE

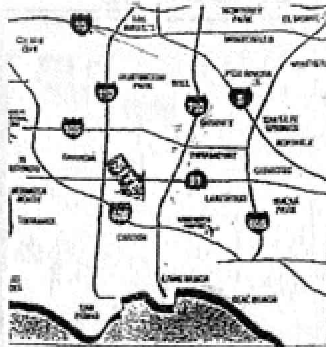

1695 E. DEL AMO BOULEVARD

- 2,372 square feet
- Concrete Tilt-up construction
- Industrial park
- Access from 91 and 710
- Major street frontage
- Rear loading door
- NO C.A.M.'s
- Unit to be refurbished



PENTA
PACIFIC

(562) 908-6012
Office Use

DOUGLAS E. WELLS
www.dewjournals.com

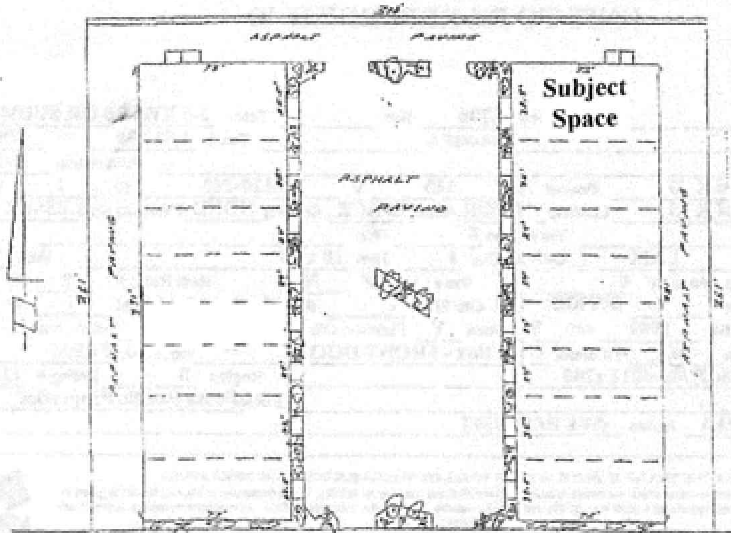

DEL AMO BLYD.